



Houston  
Botanic  
Garden

# Quality of Life Committee Meeting

March 24, 2021

# What is a botanic garden?

A botanic garden is a living museum of plant collections grown for the purpose of education, conservation, science, and display.





*Sabal mexicana*

*Phoenix canariensis*

*Lagerstroemia x*





## Mission

The mission of the Houston Botanic Garden is to enrich life through discovery, education, and the conservation of plants and the natural environment.

Life grows here.

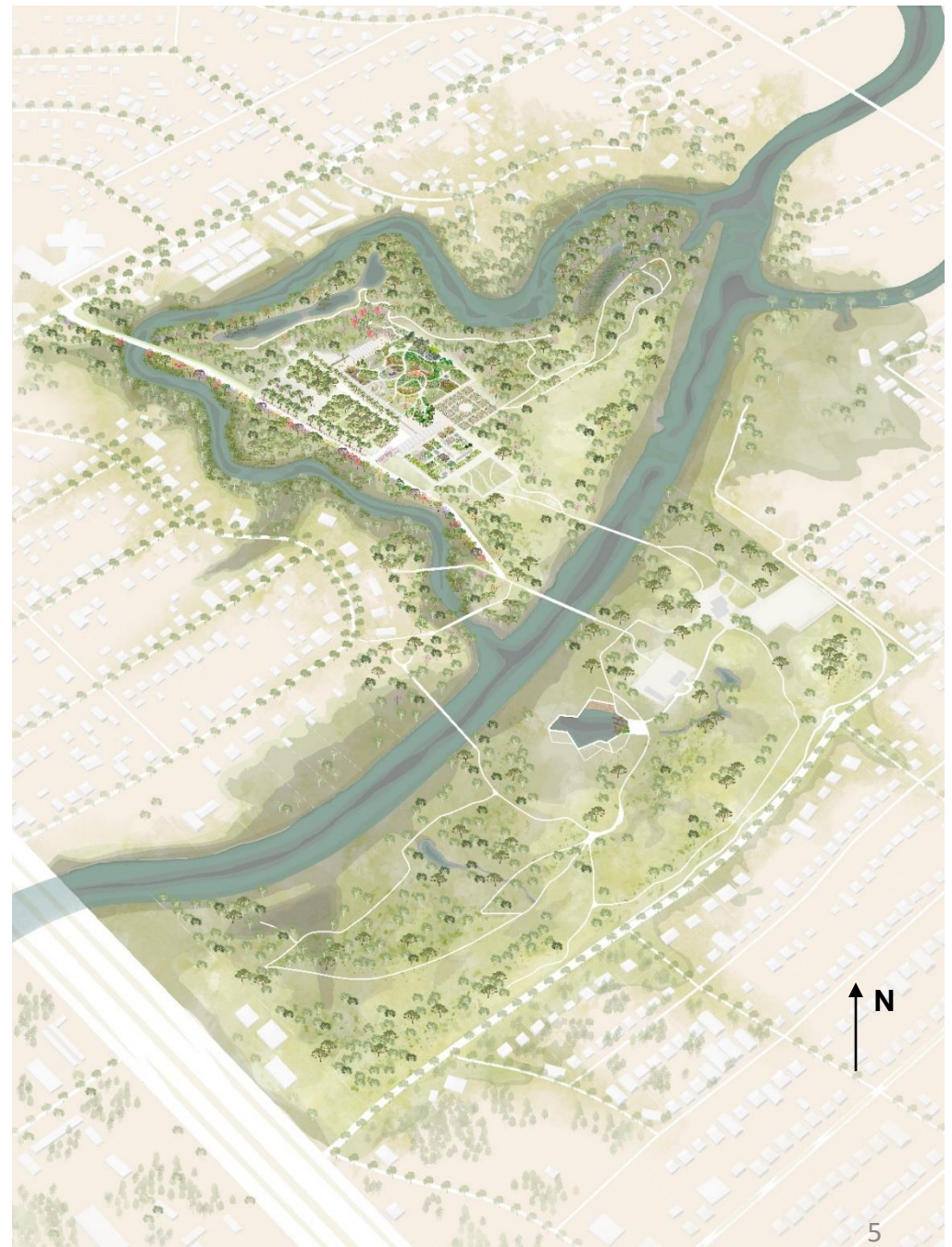

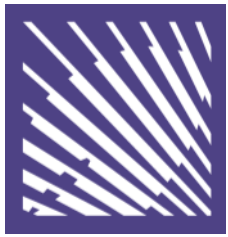

# Enjoyment & Serenity



# Urban Green Space





# Education & Discovery





# Environmental Education





# Research & Conservation



# Conserving Biodiversity



# Community Development & Environmental Justice





# Garden Location

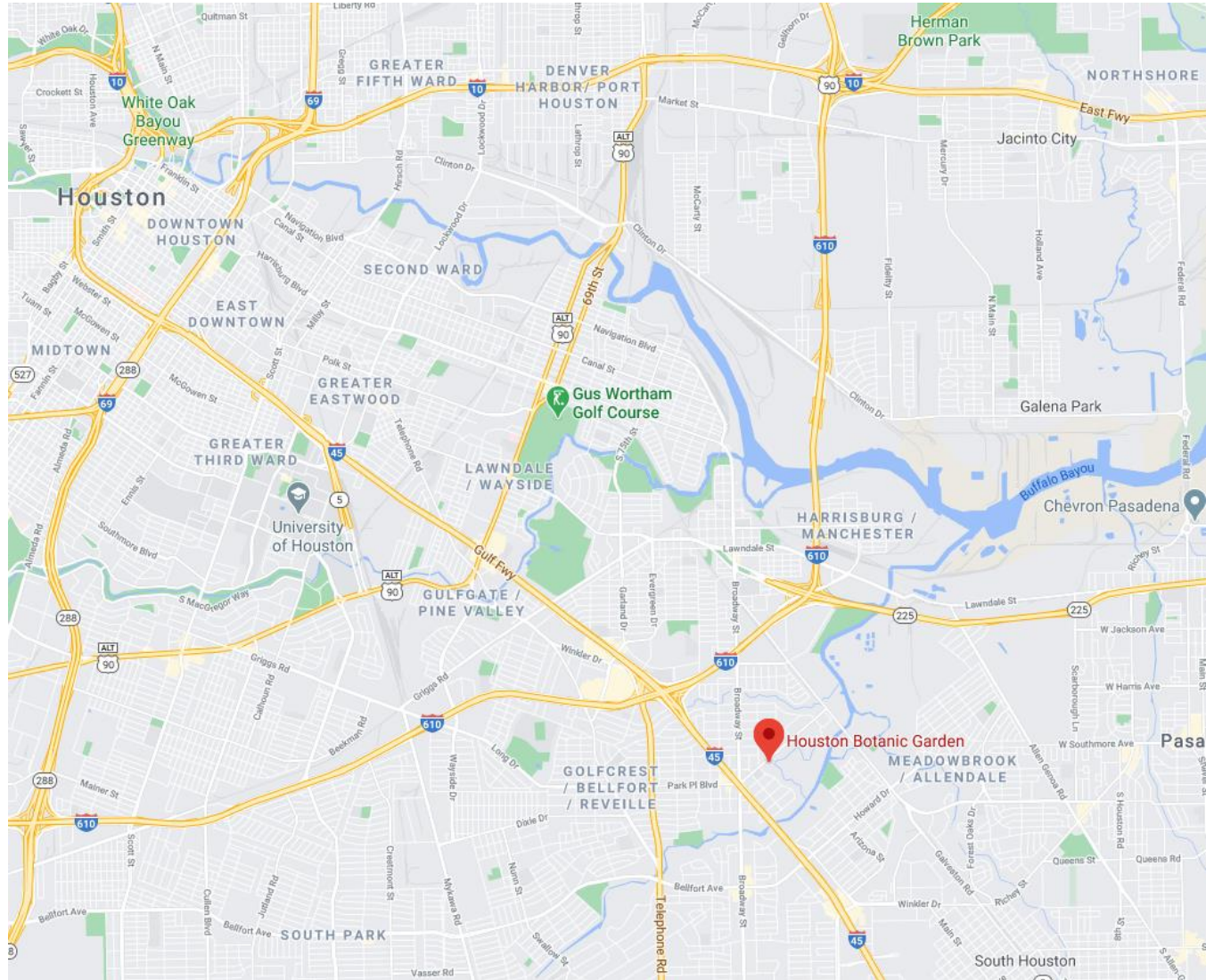



# Aerial View





# Entry to One Botanic Lane





# Welcome Pavilion







# Welcome Pavilion Entry Gate





# Pine Grove





# Entry Plaza & Fountain





# GLOBAL COLLECTION GARDEN

# GLOBAL COLLECTION GARDEN PHASE I

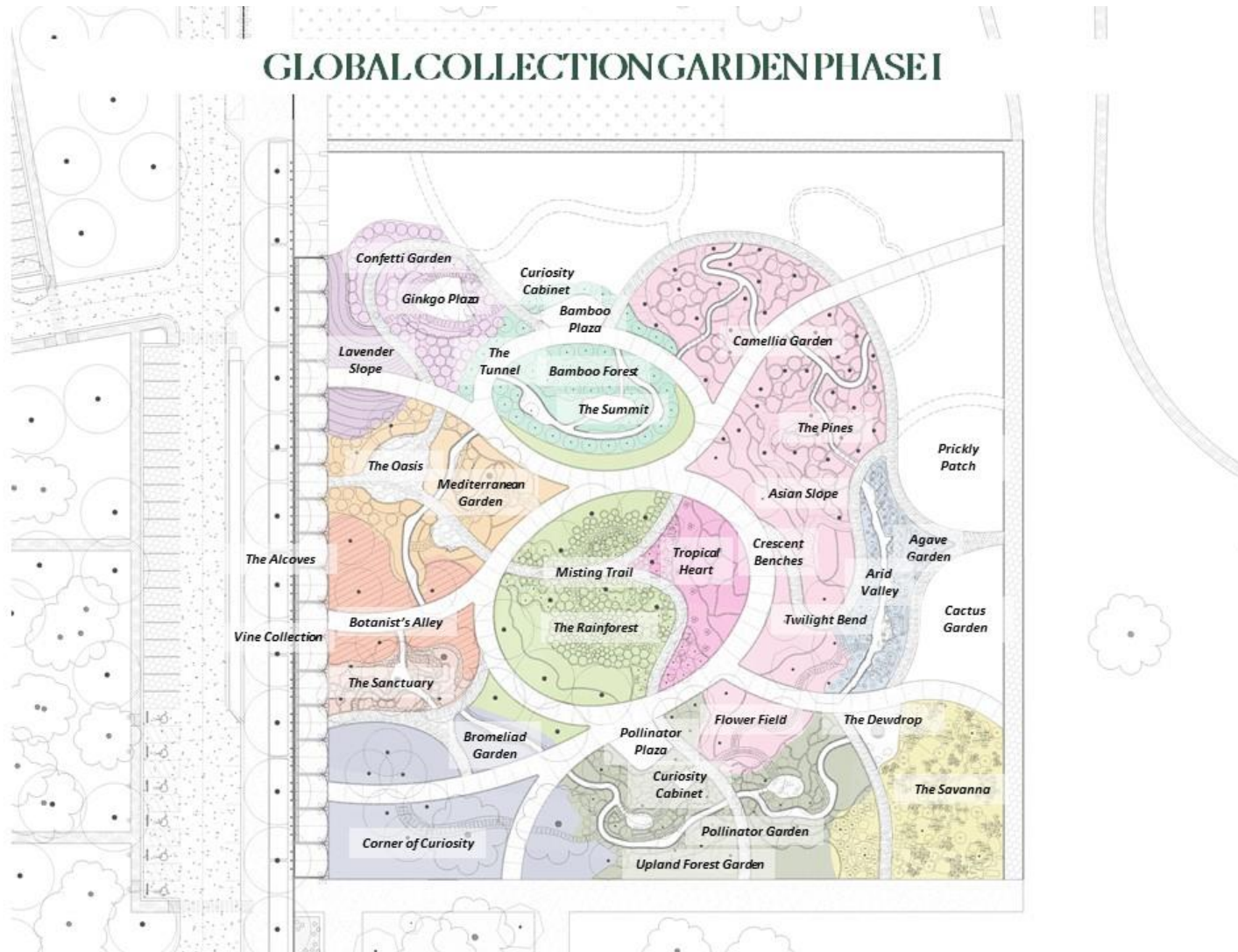



# Global Collection Garden

## Alcoves





# Global Collection Garden





# Global Collection Garden







# Global Collection Garden

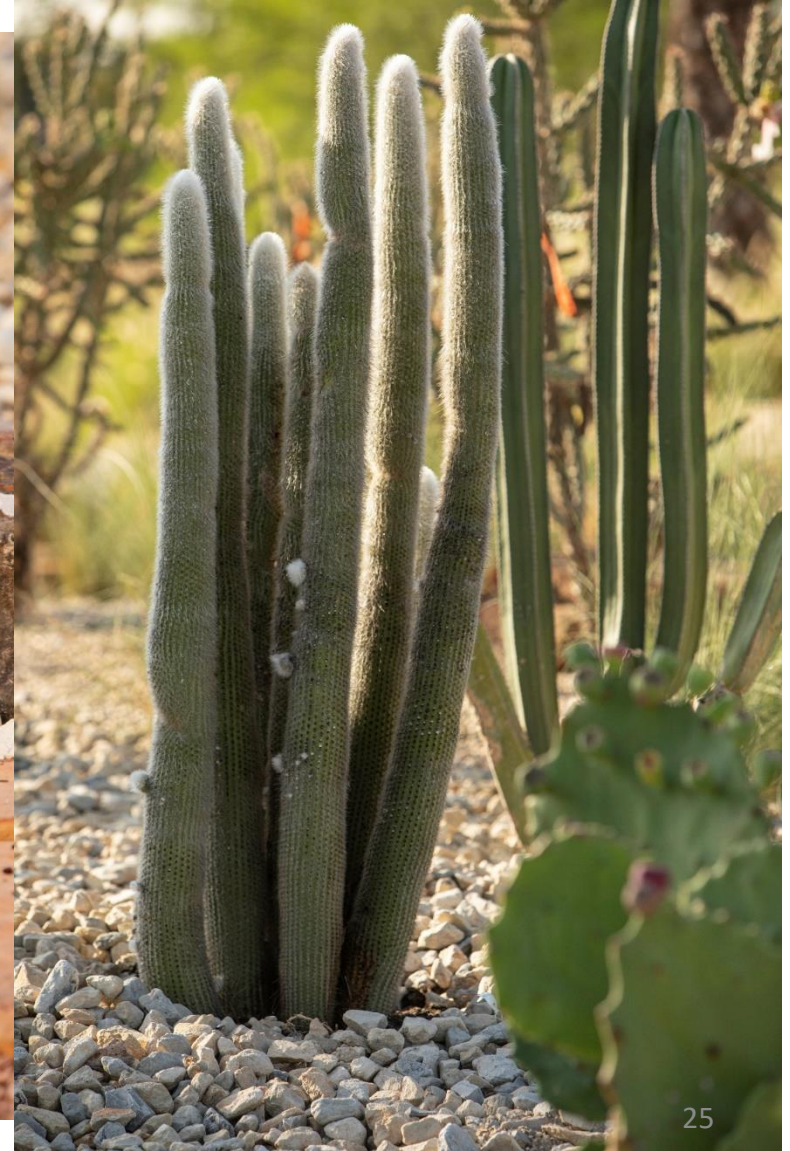



# Global Collection Garden





# Global Collection Garden





# Global Collection Garden





# Global Collection Garden





# Global Collection Garden





# Global Collection Garden





# Global Collection Garden







# Global Collection Garden

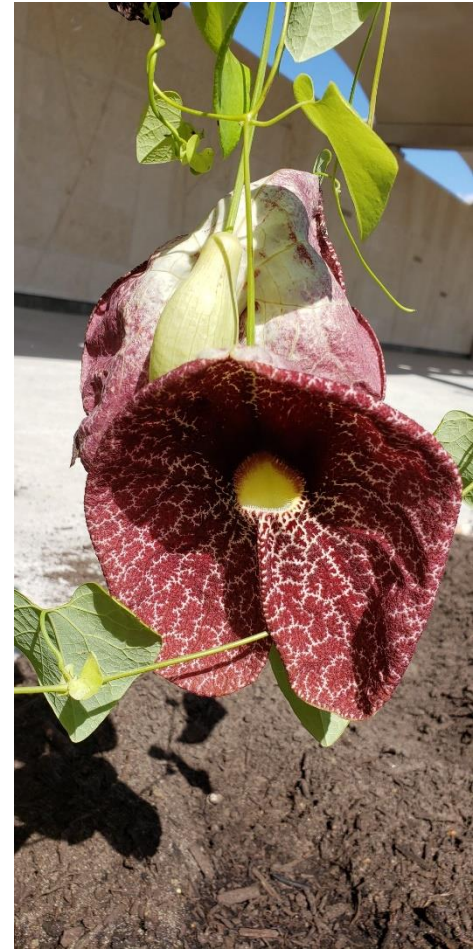



# CULINARY GARDEN

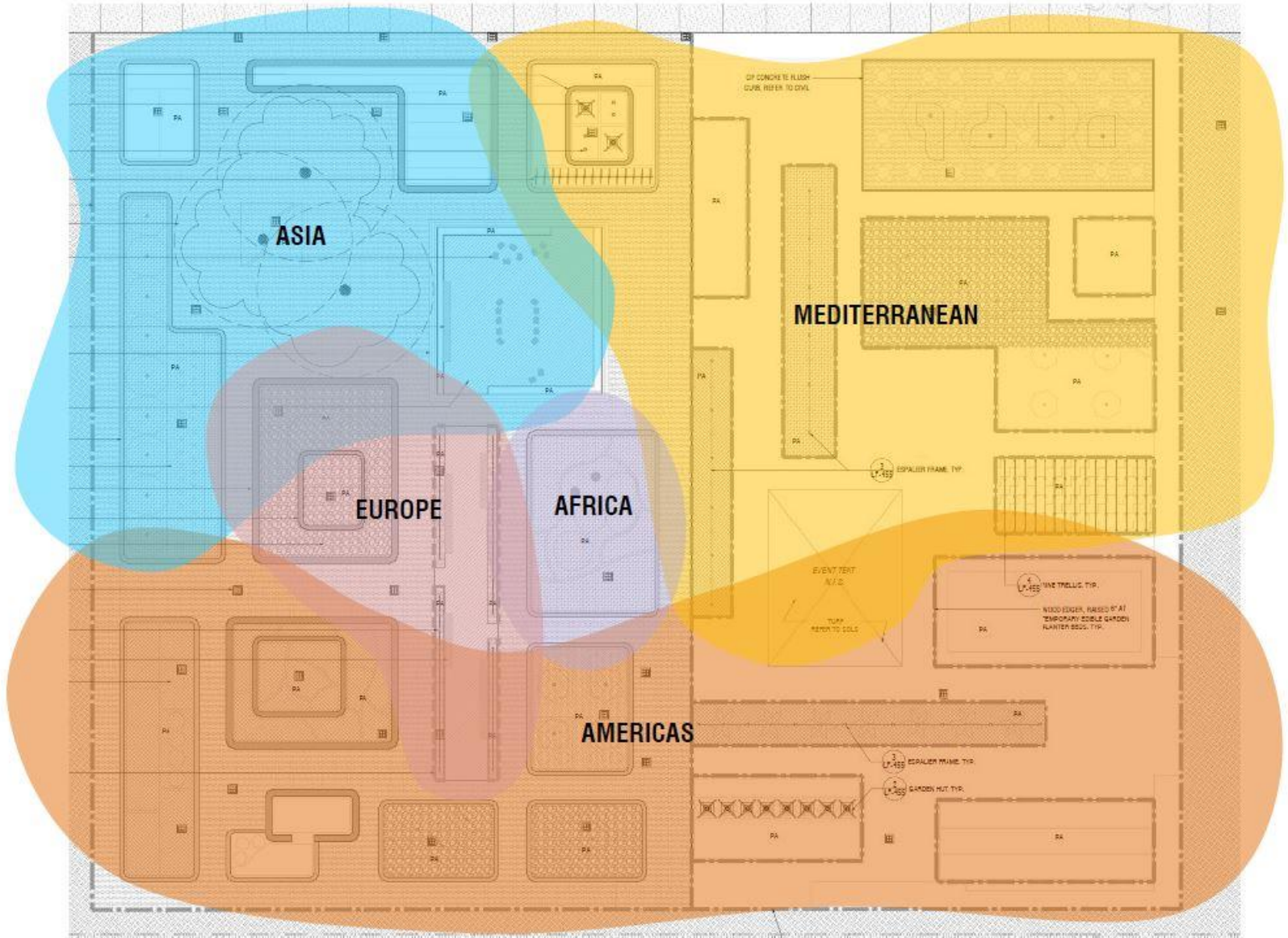



# Culinary Garden





# Culinary Garden





# Culinary Garden





# Culinary Garden





# Culinary Garden







# Culinary Garden





# WOODLAND GLADE



# Woodland Glade



The background is a soft-focus illustration of a garden. A central path leads towards the background, with a white silhouette of a person standing on it. The path is flanked by rows of pinkish-red pitcher plants. Above the path, there are trees with green leaves and clusters of small yellow flowers. Several large, green pitcher plants with reddish-orange rims hang from a branch in the upper part of the image. The overall color palette is muted and naturalistic.

# SUSAN GARVER FAMILY DISCOVERY GARDEN



**The Garver Family Garden**

Entry Plaza

Water Play

Live Oak Beach

Acorn Lawn

Cypress Swamp

Rainbow Perennial Garden

Iris Maze

Littoral Shelf

Pine Forest  
[Future 'iris' Play Structure]

King of the Hill

The Laboratory

Nature Play  
Prairie



# Susan Garver Family Discovery Garden





# Susan Garver Family Discovery Garden









# Susan Garver Family Discovery Garden





# Susan Garver Family Discovery Garden



# COMMUNITY GARDEN





# Community Garden





# NATURAL ECOSYSTEM GARDENS



# Stormwater Wetlands





# Coastal Prairie





# Winter Storm Impact







# Winter Storm Impact



A vibrant, stylized illustration of a tropical jungle. The scene is filled with various types of green plants, including large monstera leaves and ferns. In the center, a wooden building with a curved roof is partially visible. A path leads from the foreground towards the building, where several white silhouettes of people are walking. The overall atmosphere is bright and natural.

# CONNECTING PEOPLE WITH PLANTS



# Three Sisters Edible Garden, Americas





# Morus rubra (*red mulberry*)

## Global Garden, Asia





*Cyperus papyrus* (*papyrus*)  
Global Garden, Africa  
Edible Garden, Mediterranean



The background is a lush, vibrant illustration of a tropical forest. In the foreground, a stone path leads from the bottom center towards a wooden building with a curved roof in the middle ground. Several white silhouettes of people are walking along this path, some towards the building and others away from it. The forest is filled with various types of plants, including large, heart-shaped monstera leaves and ferns. The overall color palette is dominated by greens, with some warm tones like oranges and yellows in the upper right, suggesting a bright, sunny day.

# EDUCATION AND PUBLIC PROGRAMS



# Opening Season Celebrations

During the Opening Season of the Houston Botanic Garden we celebrated the importance of plants from around the world.





# Opening Season Celebrations





# Sample of Education & Programs

Meditation  
at the Garden

**Thursday, March 4**  
**12-1pm**

Alejandro Chaoul, PhD, founder and director of The Jung Center's Mind Body Spirit Institute, will guide a meditation inspired by the natural beauty of the Susan Garver Family Discovery Garden.

\$10/\$5 for members

**Gardening for Birds,  
Pollinators & Butterflies**

**Wednesday, March 24,**  
**7-8:15pm** Virtual Lecture

**Saturday, March 27**  
**10am-12pm**  
Tour/Workshop

Learn how to turn your backyard into an oasis for birds and butterflies and a flowering retreat for yourself and family. We will cover basic design concepts, proper plant selection to attract birds, butterflies, and pollinators, as well as proper planting techniques to turn your yard into a beautiful habitat.

\$20/\$15 adults (adults 18+)

Photography Workshop:  
Botany & Cyanotypes

**Saturday, March 27,**  
**1-3pm**

Photographer Anne Houang will discuss the historical botanic uses of cyanotypes, a camera-less form of photography also known as sun prints or blueprints. Participants will also create their own cyanotypes using various

\$20/\$15 members (adults 18+)

Community Garden  
Launch & Info Session

**Sunday, April 11**  
**11am-12:30pm**

During this FREE information session, the Houston Botanic Garden will share details on how community members and groups can rent plots in our new Community Garden along Glenview Dr. We will also present an educational workshop on spring fruit and vegetable gardening.

RSVP required to attend all events:  
[education@hbg.org](mailto:education@hbg.org)

# Sample of Education & Programs (Virtual)

Learn about Garden from anywhere!



## Garden Bites: Tropical & Wetlands

Virtual Lecture with the Garden's Horticulture Staff

**Tuesday, March 23,**  
**12-1pm** and a live Q&A

During this virtual session, Brent Moon, horticulture manager, and Jessica Henry, horticulturist assistant, will showcase some of the Garden's tropical and wetlands plants, through a combination of pre-recorded interviews in the Garden followed by a live Q&A chat.

Free; Zoom (link TBA)



## Garden Bites: Arid & Culinary

Virtual Lecture with the Garden's Horticulture Staff

**Tuesday, March 30**  
**12 - 1pm** and a live Q&A

During this virtual session, April Lloyd, plant recorder, and Marilyn Ventura, horticulturist assistant, will showcase some of the Garden's arid and culinary plants, through a combination of pre-recorded interviews in the Garden followed by a live Q&A chat.

Free; Zoom (link TBA)

# Sample of Education & Programs

## Docent tours



Book a tour:  
[hbg.org/visit/tours](https://hbg.org/visit/tours)

One-hour walking tour of the Global Collection Garden, led by volunteer docents, offered three times per week.

- Wednesday, Saturdays & Sundays at 9:30 a.m.
- General admission ticket + \$3/adult, \$1/child

Maximum capacity of 9 per tour (not including the docent)

Tours offered rain or shine

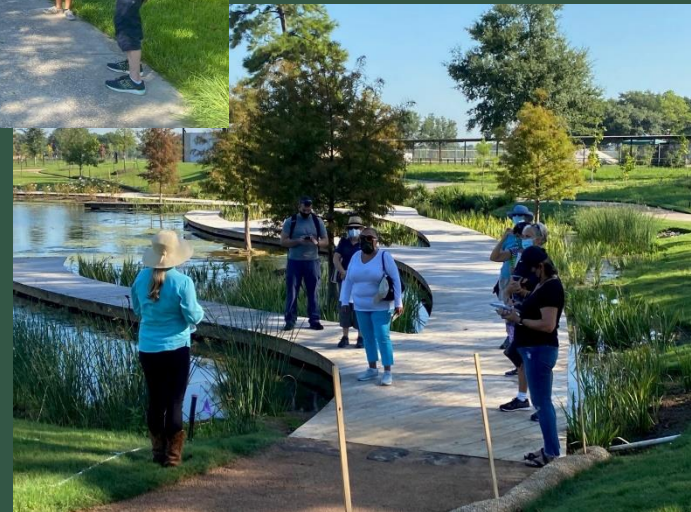

# School Programs

Chavez High School



## Environmental Studies

Feb. 19-20, 2020

March 11-12, 2020

Number of students served:  
Approx. 160 high school  
students + 2 science teachers

### Work Completed:

- Weeding
- Mulching
- Invasive plant removal
- Composting
- Raking
- Seeding
- Litter removal
- Construction of wetland nursery

# School Programs

## The Emery/Weiner School Visit



Self-Guided School Visit  
The Emery/Weiner  
School

March 2021

Number of students served:  
Over 160 6<sup>th</sup> and 7<sup>th</sup> graders

Themes explored:

- Pollination
- The role of water
- Reading plant labels

# Garden Metrics

# Garden Metrics

Attendance & Revenue

TOTAL GARDEN ATTENDANCE since opening: 26,212

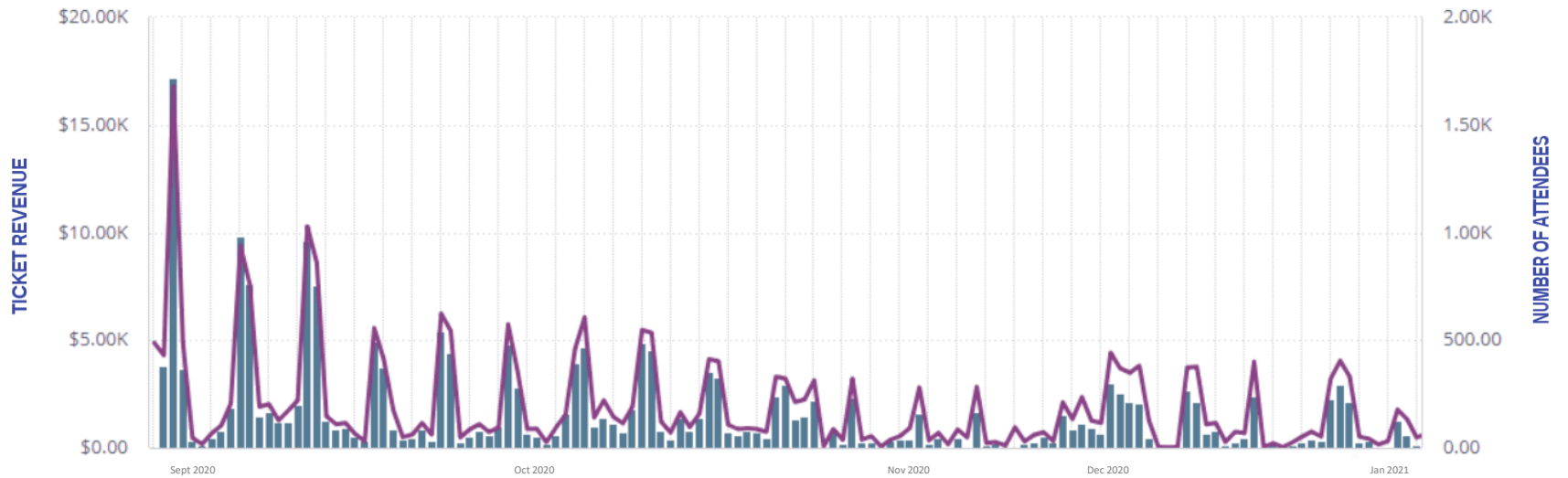

## Garden Metrics

*Attendance Heat Map of  
Top 25 Zip Codes*

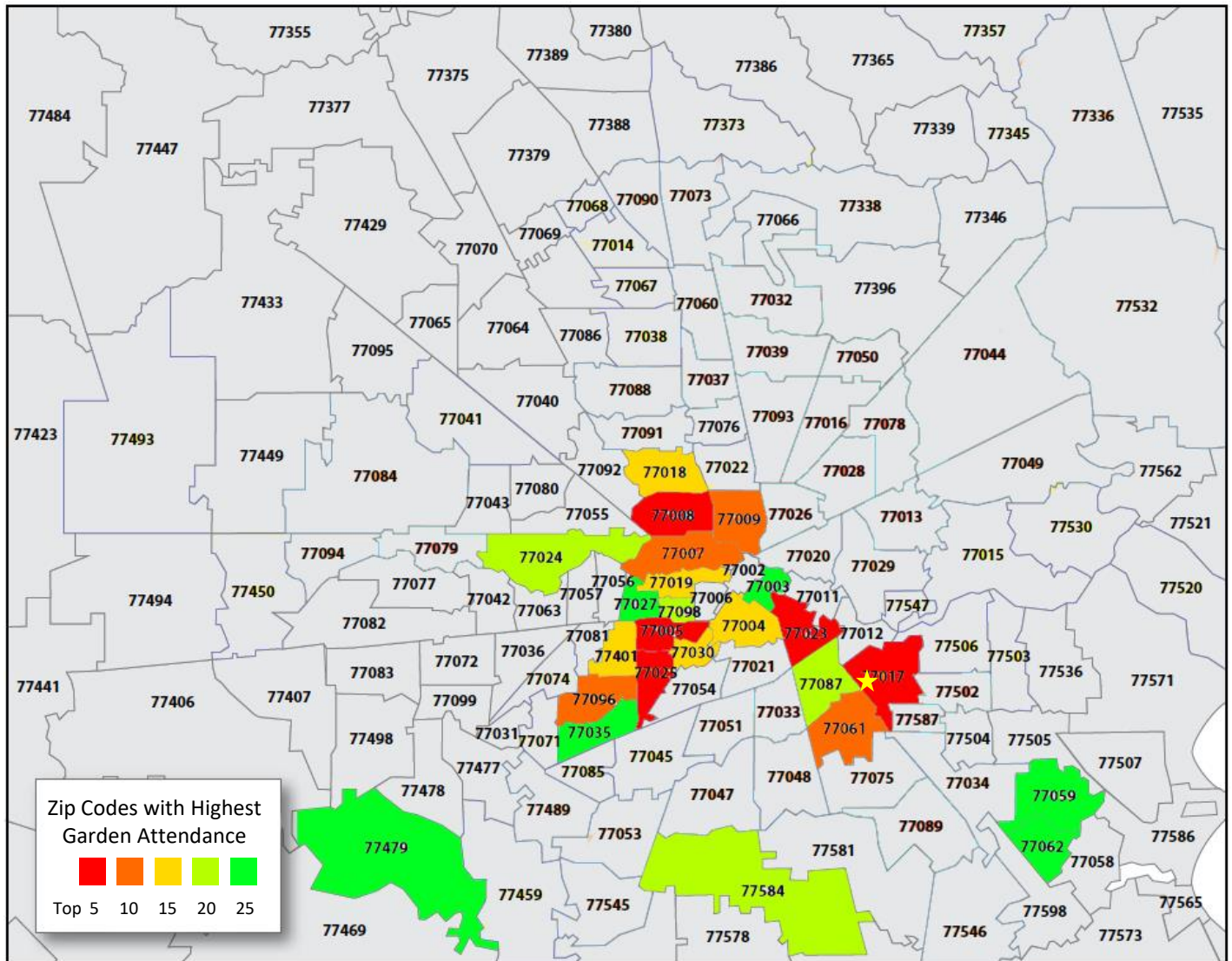



## Garden Metrics

*Membership Sales by Month*

TOTAL MEMBERSHIP HOUSEHOLDS : 2,183

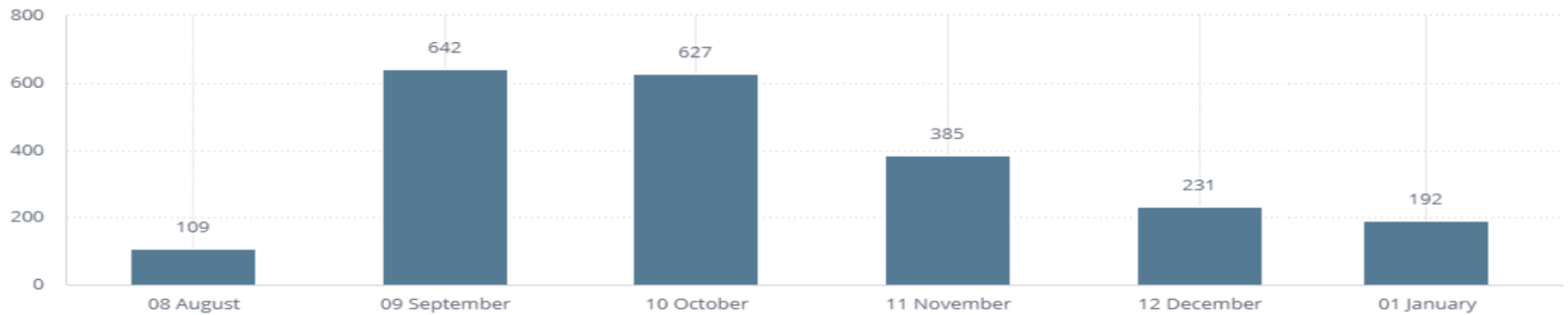



# Volunteer Opportunities

- Get your hands dirty in the Garden
- Lead visitors on guided docent tours
- Help with adult & family programs
- Serve as an ambassador for the Garden
- Provide support for special events
- Assist with administrative tasks in the office
- Participate in the Community Garden



## Garden Metrics

### *Volunteers*

*In 2020, **206 individuals** volunteered **1,914 hours** of assistance to our horticulture, visitor services, education and programs, and administrative staff.*





# Volunteer Testimonial

*“My husband and I look forward to Tuesday afternoons, when we sit at the front gate of the Garden to welcome visitors as they enter, and thank them as they leave.*

*We are now fully vaccinated. Yet, even before that, my husband, who has been very cautious, felt comfortable volunteering outdoors at the Garden, where masks are required for staff, volunteers and visitors, and there is often a breeze.*

*We know the plants are the ultimate draw, but we think it is important for Garden visitors to make a personal connection, as well. We encourage others who are able to make a commitment to volunteer time to the Garden on a regular basis. Connecting with nature, and people, always feels good.”*

Joy Lacey, Garden Volunteer





# Community Engagement Committee

## Board of Directors

- **Nancy Abendshein**, chairman
- **Jose Rocha**, committee chair

## Staff

- **Justin Lacey**, director of communication and community engagement

## Volunteers

- **Larry Bowles**, president, Park Place Civic Club
- **Tom Brents**, president, Garden Villas Civic Association
- **Francisco Castillo**, community liaison for Harris County Precinct 2 Commissioner Adrian Garcia
- **Rosalind Clifford**, past president of Meadowbrook Civic Club

## Volunteers (cont'd)

- **Ann Collum**, president, Glenbrook Valley Civic Club, and board member, Hobby Area District
- **Ramiro Fonseca**, community engagement manager, Project GRAD Houston, and member of Garden's Program Committee
- **Bo Fraga**, community engagement developer, BakerRipley
- **Victor Garay**, neighbor (lives next to our public entrance on Park Place Blvd.)
- **Chris McCarthy**, constituent services for Congresswoman Sylvia Garcia
- **Joe Edd Nelson**, board member, Hobby Area District
- **Daniel Santamaria**, Chief of Staff, Office of Council Member Robert Gallegos, City of Houston, District I
- **Mary Vargo**, board of directors, position 2, Gulfgate Redevelopment Authority, TIRZ #8

# SIMS BAYOU GREENWAY

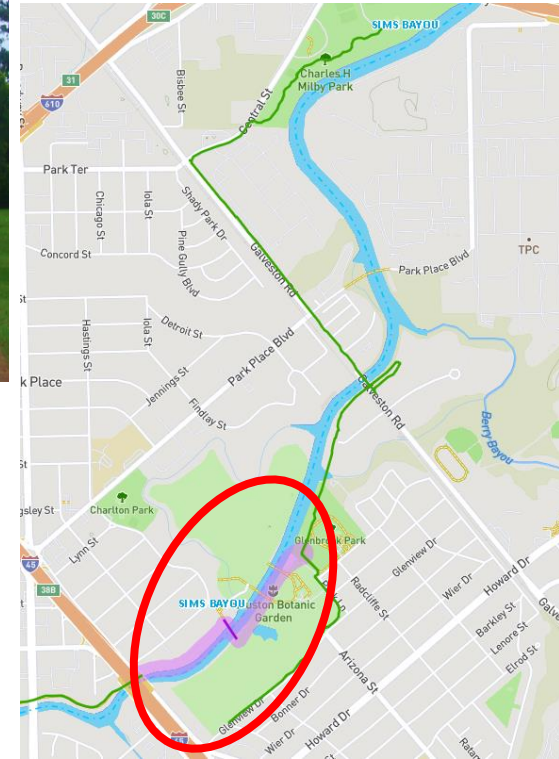

# GLENBROOK PARK TO I-45

## LEGEND

- ① RIVER DR. TRAILHEAD
- ② TRAILHEAD GATEWAY
- ③ PARKING
- ④ 6'-0" TRAIL
- ⑤ 10'-0" TRAIL
- ⑥ EXISTING BRIDGE
- ⑦ EXISTING POND
- ⑧ ARIZONA ST. GATEWAY
- ⑨ EXISTING GREENWAY
- ⑩ GLENBROOK PARK



THIS DRAWING IS CONCEPTUAL IN NATURE AND IS SUBJECT TO CHANGE. NO WARRANTIES OR REPRESENTATIONS, EXPRESSED OR IMPLIED CONCERNING THE ACCURACY, LOCATION, OR CHARACTER OF THE DATA ARE INTENDED. THIS PLAN IS NOT FOR PERMIT OR CONSTRUCTION PURPOSES.



# GLENBROOK PARK TO I-45

## LEGEND

- ① PARKING
- ② TRAIL SIGNAGE
- ③ SEATING
- ④ HABITAT GARDEN
- ⑤ TRAILHEAD GATEWAY
- ⑥ 6'-0" WALK
- ⑦ 10'-0" WALK
- ⑧ PROPOSED TREES
- ⑨ EXISTING TREES





# FORMER GOLF CART BRIDGE PROJECT





THANK YOU!